



Floor-standing vertical single-coil cylinder for the production of domestic hot water. Integrable with forced circulation solar system or high power heating system



LONG DURATION



SOLAR INTREGRABLE



INSPECTION FLANGE



MADE IN ITALY

- STEEL BOILER WITH EXCLUSIVE TITANIUM-BASED ENAMEL TREATMENT
- MAGNESIUM ANTI-CORROSION ANODE
- RECIRCULATION
- INSPECTION FLANGE
- TWO INTEGRATED PROBE-HOUSING SHEATHS
- AVAILABLE HEATING ELEMENT KIT
- INTEGRATED THERMOMETER
- PRE-ASSEMBLED FLEXIBLE REMOVABLE INSULATION
- ACTIVE ANODE AVAILABLE AS ACCESSORY

Technical data - Overall dimensions

		MAXIS CD1 800	MAXIS CD1 1000	MAXIS CD1 1500	MAXIS CD1 2000	MAXIS CD1 2500		MAXIS CD1 800	MAXIS CD1 1000	MAXIS CD1 1500	MAXIS CD1 2000	MAXIS CD1 2500
Capacity	l	800	1000	1500	2000	2500	A mm	295	295	365	435	400
Max. working pressure (EN 12897-2006)	bar	7	7	7	7	7	B mm	415	425	495	560	555
Max. working cylinder temperature	°C	95	95	95	95	95	C mm	795	865	980	1060	1065
Solar coil surface	m ²	2,5	3	4,5	5,4	6	D mm	895	965	1080	1160	1165
Solar coil capacity	l	14,2	18	26,6	32,6	36,6	E mm	1195	1315	1435	1460	1535
Max. working coil temperature	°C	110	110	110	110	110	F mm	1560	1810	1880	1710	1970
Coil power at 900 l/h	kW	22/23,8	30,9/39,5	30,9 / 39,5	39,9 / 57,5	46,1 / 65,3	G mm	1665	1915	1985	1820	2080
(according to EN12897/EN15332)							H mm	800	830	905	975	960
Coil load losses at 900 l/h	mbar	21	33	33	44	48	I mm	1260	1395	1505	1525	1660
Max. coil working pressure	bar	10	10	10	10	10	J mm	1540	1790	1875	1695	1955
Cylinder's thermal dispersions	kWh/24h	5,62	6,03	5,97	8,31	8,88	K mm	1945	2195	2335	2245	2465
Empty mass	kg	246	272	420	487	630	L mm	900	930	1005	1075	1060
							M mm					1590
							N mm	1500	1765	1750	1650	1920
							O mm	790	790	1000	1200	1250
							P mm	990	990	1200	1400	1450
							Q mm	1010	1010	1220	1420	1470

CODE

3507115 3507116 3507125 3507126 3507127

1. Cold water inlet G2" F
2. Hot water outlet G 2" F
3. Recirculation G 1 1/2" F
4. Heating element G 1 1/2" F
5. Draining fitting connection G 1 1/4" F
6. Well G 1/2" F
7. Flange ø 400
8. Magnesium anode G 1 1/4" F
9. Thermometer
10. Primary circuit flow G 1 1/2" F
11. Primary circuit return G 1 1/2" F
12. Upper fitting connection G 1 1/4" F

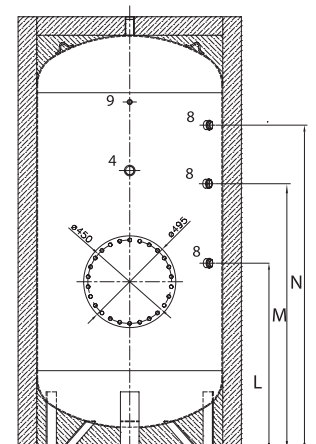
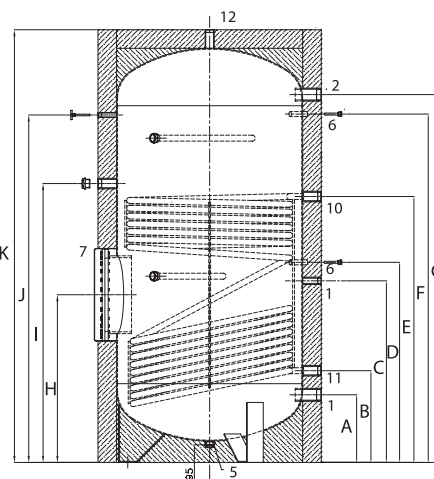
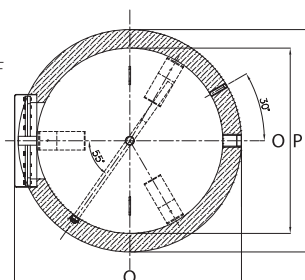

For the whole accessory list see page 40